

5/8" Square Drive Sockets METRIC

6 Point and Surface Drive, Standard Length

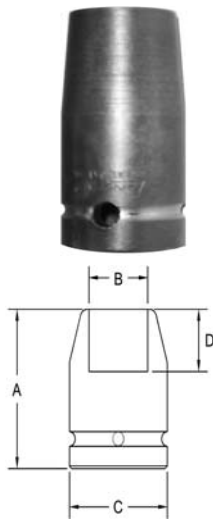

Part # 6 Point	Part # Surface Drive	Hex Opening	Overall Length (A)	Diameter Nose (B)	Diameter Drive End (C)	Opening Depth (D)
4300	SF-4300	15	48	23.8	31.8	11.1
4301	SF-4301	16	48	25.4	31.8	11.1
4302	SF-4302	17	48	28.6	31.8	11.1
4303	SF-4303	18	48	28.5	31.8	11.1
4304	SF-4304	19	48	31.8	31.8	11.9
4305	SF-4305	20	48	31.8	31.8	11.9
4306	SF-4306	21	48	31.8	31.8	13.5
4307	SF-4307	22	48	34.9	34.9	14.3
4308	SF-4308	23	48	34.9	34.9	15.9
4309	SF-4309	24	51	38.1	38.1	15.9

6 Point and Surface Drive, Extra Long Length

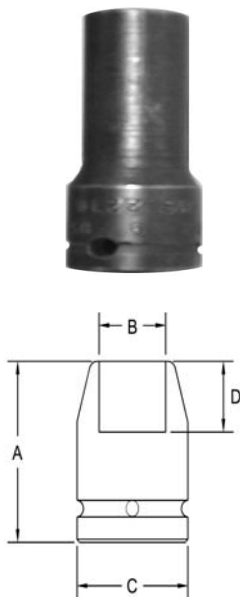

Part # 6 Point	Part # Surface Drive	Hex Opening	Overall Length (A)	Diameter Nose (B)	Diameter Drive End (C)	Opening Depth (D)
4349	SF-4349	15	89	23.8	31.8	11.1
4350	SF-4350	17	89	25.4	31.8	11.1
4351	SF-4351	18	89	28.6	31.8	11.1
4352	SF-4352	19	89	31.8	31.8	11.9
4353	SF-4353	21	89	31.8	31.8	13.5
4354	SF-4354	22	89	34.9	34.9	14.3
4355	SF-4355	23	89	34.9	34.9	15.9
4356	SF-4356	24	89	38.1	38.1	15.9

Sockets can be configured with the following options:

FM = Fixed Magnet SD = Side Magnet TM = Tubular Magnet

SM = Spring Magnet FL = Fast Lead

Fixed and rotating UHMW plastic sleeves can be special ordered