

5/8' Square Drive Sockets

Surface Drive, Standard Length

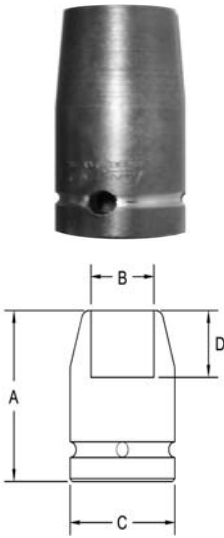

Part # Surface Drive	Hex Opening	Overall Length (A)	Diameter Nose (B)	Diameter Drive End (C)	Opening Depth (D)
SF-4127	9/16	1.87	.875	1.25	.437
SF-4128	9/16	1.87	.875	1.25	.437
SF-4129	5/8	1.87	1.00	1.25	.437
SF-4130	11/16	1.87	1.12	1.25	.437
SF-4131	3/4	1.87	1.25	1.25	.468
SF-4131	3/4	1.87	1.06	1.25	.468
SF-4131	13/16	1.87	1.25	1.25	.531
SF-4132	7/8	1.87	1.37	1.37	.562
SF-4133	15/16	2.00	1.50	1.50	.625
SF-4134	1	2.00	1.62	1.62	.625

Surface Drive, Extra Long Length

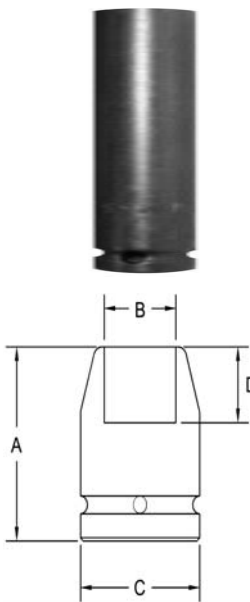

Part # Surface Drive	Hex Opening	Overall Length (A)	Diameter Nose (B)	Diameter Drive End (C)	Opening Depth (D)
SF-4154	5/8	3.50	1.00	1.25	.437
SF-4155	5/8	3.50	.937	1.25	.437
SF-4156	11/16	3.50	1.00	1.25	.437
SF-4157	3/4	3.50	1.25	1.25	.468
SF-4158	3/4	3.50	1.06	1.25	.468
SF-4159	13/16	3.50	1.25	1.25	.531
SF-4160	13/16	3.50	1.12	1.25	.531
SF-4161	7/8	3.50	1.37	1.37	.562
SF-4162	15/16	3.50	1.50	1.50	.625

Sockets can be configured with the following options:
FM = Fixed Magnet SD = Side Magnet TM = Tubular Magnet
SM = Spring Magnet FL = Fast Lead
Fixed and rotating UHMW plastic sleeves can be special ordered