

5/8" Square Drive Sockets

6 Point and Double Hex, Standard Length

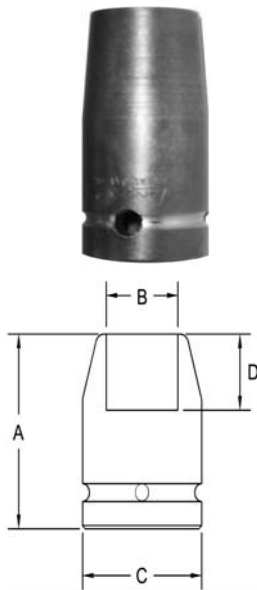

Part # 6 Point	Part # Double Hex	Hex Opening	Overall Length (A)	Diameter Nose (B)	Diameter Drive End (C)	Opening Depth (D)
4000	4000-D	1/2	1.87	.812	1.25	.343
4001	4001-D	9/16	1.87	.875	1.25	.437
4002	4002-D	5/8	1.87	1.00	1.25	.437
4003	4003-D	11/16	1.87	1.12	1.25	.437
4004	4004-D	3/4	1.87	1.25	1.25	.468
4005	4005-D	13/16	1.87	1.25	1.25	.531
4006	4006-D	7/8	1.87	1.37	1.37	.562
4007	4007-D	15/16	2.00	1.50	1.50	.625
4008	4008-D	1	2.00	1.62	1.62	.625
4009	4009-D	1 1/16	2.00	1.62	1.62	.687
4010	4010-D	1 1/8	2.00	1.62	1.62	.750
4011	4011-D	1 3/16	2.00	1.75	1.75	.750
4012	4012-D	1 1/4	2.00	1.87	1.87	.812
4013	4013-D	1 5/16	2.00	2.00	2.00	.812
4014	4014-D	1 3/8	2.12	2.00	2.00	.812
4015	4015-D	1 7/16	2.12	2.12	2.12	.937
4016	4016-D	1 1/2	2.25	2.12	2.12	1.00

6 Point and Double Hex, Thin Wall Standard Length

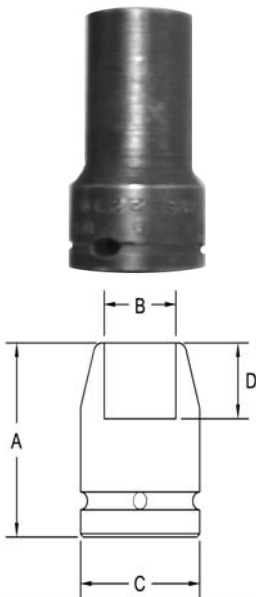

Part # 6 Point	Part # Double Hex	Hex Opening	Overall Length (A)	Diameter Nose (B)	Diameter Drive End (C)	Opening Depth (D)
4036	4036-D	7/16	1.87	.687	1.25	.281
4037	4037-D	9/16	1.87	.875	1.25	.437
4038	4038-D	5/8	1.87	.937	1.25	.437
4039	4039-D	3/4	1.87	1.06	1.25	.468
4040	4040-D	13/16	1.87	1.12	1.25	.531
4041	4041-D	7/8	1.87	1.18	1.25	.562
4042	4042-D	15/16	2.00	1.31	1.31	.625
4043	4043-D	1	2.00	1.37	1.37	.625
4044	4044-D	1 1/16	2.00	1.50	1.50	.687
4045	4045-D	1 1/8	2.00	1.50	1.50	.750
4046	4046-D	1 1/4	2.00	1.75	1.75	.812
4047	4047-D	1 3/8	2.12	1.87	1.87	.812

Sockets can be configured with the following options:

FM = Fixed Magnet SD = Side Magnet TM = Tubular Magnet
SM = Spring Magnet FL = Fast Lead

Fixed and rotating UHMW plastic sleeves can be special ordered