

# 3/8" Square Drive Sockets

## Surface Drive, Short and Standard Length

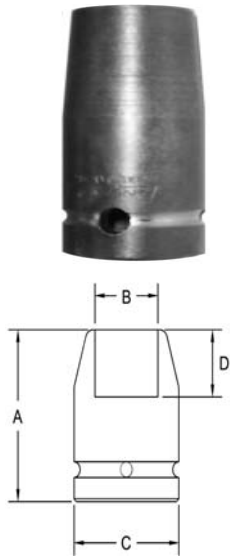

Part # Surface Drive	Hex Opening	Overall Length (A)	Diameter Nose (B)	Diameter Drive End (C)	Opening Depth (D)
SF-2132	1/4	1.25	.437	.750	.156
SF-2133	5/16	.875	.500	.750	.187
SF-2134	5/16	1.25	.500	.750	.187
SF-2135	3/8	.875	.593	.750	.187
SF-2136	3/8	1.25	.593	.750	.250
SF-2137	7/16	.875	.687	.750	.281
SF-2138	7/16	1.50	.687	.750	.281
SF-2139	1/2	.875	.812	.812	.312
SF-2140	1/2	1.50	.812	.812	.343
SF-2141	9/16	.875	.875	.875	.312
SF-2142	9/16	1.50	.875	.875	.437
SF-2143	19/32	1.50	.875	.875	.437
SF-2144	5/8	1.00	.937	.937	.437
SF-2145	5/8	1.50	.937	.937	.437
SF-2146	11/16	1.00	.937	.937	.437
SF-2147	11/16	1.50	1.00	1.00	.437
SF-2148	3/4	1.00	1.06	1.06	.437
SF-2149	3/4	1.50	1.06	1.06	.468
SF-2150	7/8	1.00	1.25	1.25	.562

## Surface Drive, Thin Wall, Standard Length

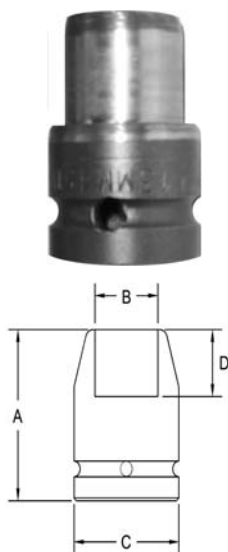

Part # Surface Drive	Hex Opening	Overall Length (A)	Diameter Nose (B)	Diameter Drive End (C)	Opening Depth (D)
SF-2165	5/16	1.25	.500	.750	.187
SF-2166	3/8	1.50	.593	.750	.250
SF-2167	7/16	1.50	.625	.750	.281
SF-2168	1/2	1.50	.750	.750	.343
SF-2169	9/16	1.50	.781	.812	.437
SF-2170	5/8	1.50	.875	.875	.437
SF-2171	11/16	1.50	.937	.937	.437
SF-2172	15/16	1.50	1.31	1.31	.437
SF-2173	1	1.50	1.37	1.37	.625

**Sockets can be configured with the following options:**  
**FM = Fixed Magnet    SD = Side Magnet    TM = Tubular Magnet**  
**SM = Spring Magnet    FL = Fast Lead**  
**Fixed and rotating UHMW plastic sleeves can be special ordered**