

3/8" Square Drive Sockets

6 Point and Double Hex, Thin Wall, Long Length

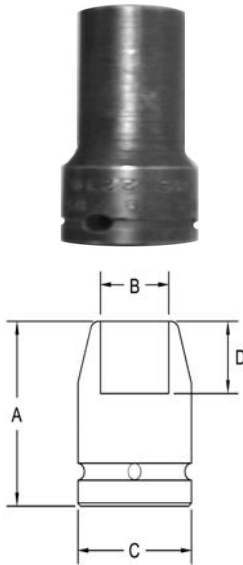

Part # 6 Point	Part # Double Hex	Hex Opening	Overall Length (A)	Diameter Nose (B)	Diameter Drive End (C)	Opening Depth (D)
2107	2170-D	5/16	2.00	.500	.750	.187
2108	2108-D	11/32	2.00	.500	.750	.187
2109	2109-D	3/8	2.00	.593	.750	.250
2110	2110-D	3/8	2.00	.625	.750	.250
2111	2111-D	7/16	2.00	.625	.750	.281
2112	2112-D	1/2	2.00	.750	.750	.343
2113	2113-D	9/16	2.00	.781	.812	.437
2114	2114-D	11/16	2.00	.937	.937	.437
2115	2115-D	3/4	2.00	1.00	1.00	.468
2116	2116-D	15/16	2.00	1.31	1.31	.625
2117	2117-D	1	2.00	1.37	1.37	.625
2118	2118-D	1 1/16	2.00	1.50	1.50	.687

Sockets can be configured with the following options:
FM = Fixed Magnet SD = Side Magnet TM = Tubular Magnet
SM = Spring Magnet FL = Fast Lead
Fixed and rotating UHMW plastic sleeves can be special ordered