

3/8" Square Drive Sockets METRIC

6 Point and Double Hex, Thin Wall Standard Length

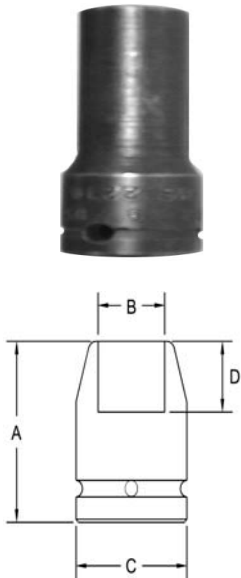

Part # 6 Point	Part # Double Hex	Hex Opening	Overall Length (A)	Diameter Nose (B)	Diameter Drive End (C)	Opening Depth (D)
2357	2357-D	6	31.7	9.5	19.1	3.9
2358	2358-D	7	31.7	11.1	19.1	4.8
2359	2359-D	8	31.7	12.7	19.1	4.8
2360	2360-D	9	31.7	12.7	19.1	4.8
2361	2361-D	10	31.7	15.1	19.1	6.4
2362	2362-D	11	38.1	15.9	19.1	7.2
2363	2363-D	12	38.1	17.5	19.1	7.2
2364	2364-D	13	38.1	19.1	19.1	8.7
2365	2365-D	14	38.1	19.8	20.6	11.1
2366	2366-D	15	38.1	20.6	20.6	11.1
2367	2367-D	16	38.1	22.2	22.2	11.1
2368	2368-D	17	38.1	23.8	23.8	11.1
2369	2369-D	18	38.1	23.8	23.8	11.1
2370	2370-D	19	38.1	25.4	25.4	11.9

Sockets can be configured with the following options:
FM = Fixed Magnet SD = Side Magnet TM = Tubular Magnet
SM = Spring Magnet FL = Fast Lead
Fixed and rotating UHMW plastic sleeves can be special ordered

3/8" Square Drive METRIC

Impact Hex Drivers

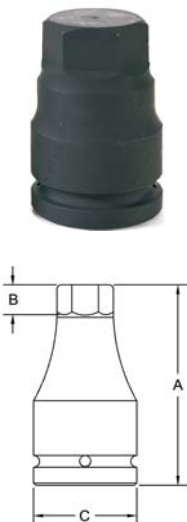

Part # Hex	Hex Size	Overall Length (A)	Depth Nose (B)	Diameter Drive End (C)
0280	4	1.98	.51	.75
0281	5	1.98	.51	.75
0282	6	1.98	.51	.75
0283	7	1.98	.51	.75
0284	8	1.98	.51	.75
0285	10	1.98	.51	.75
0286	12	1.98	.51	.75