

3/8" Square Drive Sockets METRIC

6 Point and 12 Point, Short and Standard Length

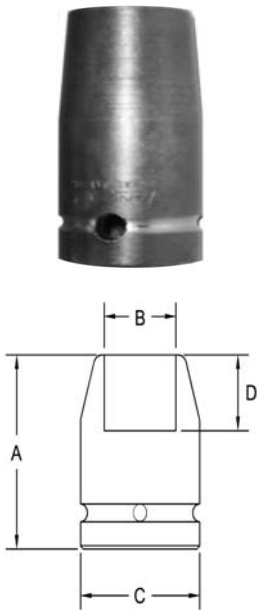

Part # 6 Point	Part # 12 Point	Hex Opening	Overall Length (A)	Diameter Nose (B)	Diameter Drive End (C)	Opening Depth (D)
2310	2310-D	6	31.7	11.1	19.1	3.9
2311	2311-D	7	22.2	11.1	19.1	3.0
2312	2312-D	7	31.7	11.1	19.1	4.8
2313	2313-D	8	22.2	12.7	19.1	4.8
2314	2314-D	8	31.7	12.7	19.1	4.8
2315	2315-D	9	22.2	15.1	19.1	4.8
2316	2316-D	9	31.7	15.1	19.1	4.8
2317	2317-D	10	22.2	16.8	19.1	6.4
2318	2318-D	10	31.7	16.8	19.1	6.4
2319	2319-D	11	22.2	17.5	19.1	7.2
2320	2320-D	11	31.7	17.5	19.1	7.2
2321	2321-D	12	22.2	19.1	19.1	7.2
2322	2322-D	12	38.1	19.1	19.1	7.2
2323	2323-D	13	22.2	20.6	20.6	7.9
2324	2324-D	13	38.1	20.6	20.6	8.7
2325	2325-D	14	22.2	22.2	22.2	7.9
2326	2326-D	14	38.1	22.2	22.2	11.1
2327	2327-D	15	23.8	22.2	22.2	9.5
2328	2328-D	15	38.1	22.2	22.2	11.1
2329	2329-D	16	25.4	23.8	23.8	11.1
2330	2330-D	16	38.1	23.8	23.8	11.1
2331	2331-D	17	25.4	25.4	25.4	11.1
2332	2332-D	17	38.1	25.4	25.4	11.1
2333	2333-D	18	25.4	25.4	25.4	11.1
2334	2334-D	18	38.1	25.4	25.4	11.1
2335	2335-D	19	25.4	28.6	28.6	11.1
2336	2336-D	19	38.1	28.6	28.6	11.9
2337	2337-D	20	25.4	28.6	28.6	11.1
2338	2338-D	20	38.1	28.6	28.6	11.9
2339	2339-D	21	25.4	31.7	31.7	11.1
2340	2340-D	21	38.1	31.7	31.7	13.5
2341	2341-D	22	25.4	31.7	31.7	11.1
2342	2342-D	22	38.1	31.7	31.7	14.3

Sockets can be configured with the following options:
FM = Fixed Magnet SD = Side Magnet TM = Tubular Magnet
SM = Spring Magnet FL = Fast Lead
Fixed and rotating UHMW plastic sleeves can be special ordered