

3/4" Square Drive Sockets

6 Point and Double Hex, Standard Length

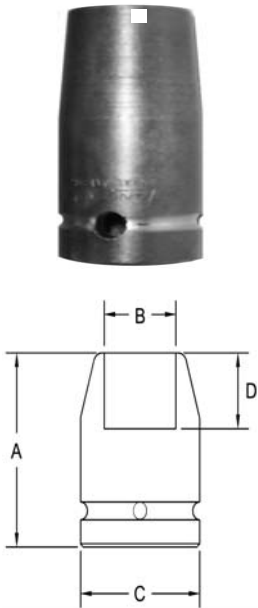

Part # 6 Point	Part # Double Hex	Hex Opening	Overall Length (A)	Diameter Nose (B)	Diameter Drive End (C)	Opening Depth (D)
5100	5100-D	1/4	2	.812	1.50	.343
5101	5101-D	9/16	2	.875	1.50	.437
5102	5102-D	5/8	2	1.06	1.50	.437
5103	5103-D	11/16	2	1.12	1.50	.437
5104	5104-D	3/4	2	1.25	1.50	.468
5105	5105-D	13/16	2	1.37	1.50	.531
5106	5106-D	7/8	2	1.50	1.50	.562
5107	5107-D	15/16	2	1.50	1.50	.625
5108	5108-D	1	2	1.62	1.62	.625
5109	5109-D	1 1/16	2	1.75	1.75	.687
5110	5110-D	1 1/8	2.12	1.75	1.75	.750
5111	5111-D	1 3/16	2.12	1.87	1.75	.750
5112	5112-D	1 1/4	2.12	2.00	1.75	.812
5113	5113-D	1 5/16	2.12	2.00	1.75	.812
5114	5114-D	1 3/8	2.12	2.12	2.12	.812
5115	5115-D	1 7/16	2.25	2.25	2.12	.937
5116	5116-D	1 1/2	2.25	2.25	2.12	1.00
5117	5117-D	1 9/16	2.25	2.37	2.12	1.00
5118	5118-D	1 5/8	2.25	2.50	2.12	1.12
5119	5119-D	1 11/16	2.25	2.50	2.12	1.12
5120	5120-D	1 3/4	2.25	2.62	2.12	1.12
5121	5121-D	1 13/16	2.25	2.75	2.12	1.25
5122	5122-D	1 7/8	2.25	2.75	2.12	1.25
5123	5123-D	1 15/16	2.25	2.87	2.12	1.25
5124	5124-D	2	2.37	2.87	2.12	1.37
5125	5125-D	2 1/16	2.37	3.00	2.12	1.37
5126	5126-D	2 1/8	2.37	3.12	2.12	1.37
5127	5127-D	2 3/16	2.50	3.12	2.12	1.50
5128	5128-D	2 1/4	2.50	3.25	2.12	1.50
5129	5129-D	2 5/16	2.50	3.37	2.12	1.50
5130	5130-D	2 3/8	2.62	3.50	2.12	1.62
5131	5131-D	2 7/16	2.62	3.50	2.12	1.62
5132	5132-D	2 1/2	2.62	3.50	2.12	1.62

Sockets can be configured with the following options:
FM = Fixed Magnet SD = Side Magnet TM = Tubular Magnet
SM = Spring Magnet FL = Fast Lead
Fixed and rotating UHMW plastic sleeves can be special ordered