

1/2" Square Drive Sockets METRIC

Surface Drive, Thin Wall, Extra Long Length

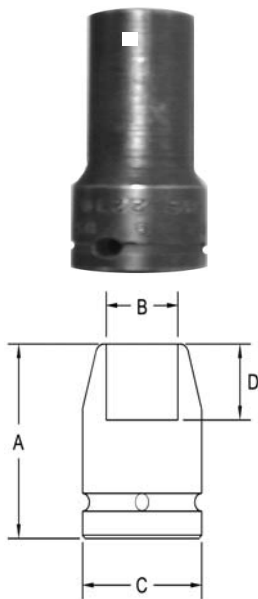

Part # Surface Drive	Hex Opening	Overall Length (A)	Diameter Nose (B)	Diameter Drive End (C)	Opening Depth (D)
SF-3820	10	82.5	15.9	23.8	6.4
SF-3821	11	82.5	16.7	23.8	7.2
SF-3822	12	82.5	17.5	23.8	8.7
SF-3823	13	82.5	18.7	23.8	11.1
SF-3824	14	82.5	20.6	23.8	11.1
SF-3825	15	82.5	22.2	23.8	11.1
SF-3826	16	82.5	22.2	23.8	11.1
SF-3827	17	82.5	23.8	23.8	11.1
SF-3828	18	82.5	25.4	25.4	11.1
SF-3829	19	82.5	26.3	26.3	11.9
SF-3830	21	88.9	28.6	28.6	13.5
SF-3831	22	88.9	30.2	31.7	15.9

Sockets can be configured with the following options:
FM = Fixed Magnet SD = Side Magnet TM = Tubular Magnet
SM = Spring Magnet FL = Fast Lead
Fixed and rotating UHMW plastic sleeves can be special ordered