

1/2" Square Drive Sockets METRIC

Surface Drive, Long Length

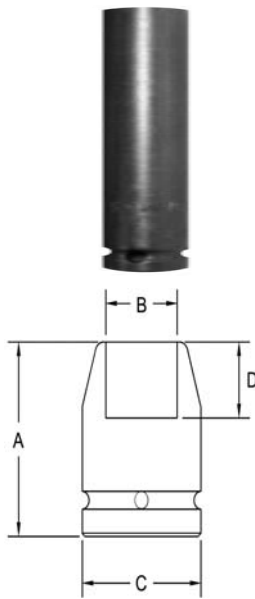

Part # Surface Drive	Hex Opening	Overall Length (A)	Diameter Nose (B)	Diameter Drive End (C)	Opening Depth (D)
SF-3756	10	57.1	16.7	23.8	6.4
SF-3757	11	57.1	17.5	23.8	7.2
SF-3758	12	57.1	19.1	23.8	7.2
SF-3758	13	57.1	22.2	23.8	7.2
SF-3759	14	57.1	22.2	23.8	11.1
SF-3760	15	57.1	23.8	23.8	11.1
SF-3761	16	57.1	25.4	25.4	11.1
SF-3762	17	57.1	28.6	28.6	11.1
SF-3763	18	57.1	28.6	28.6	11.1
SF-3764	19	57.1	28.6	28.6	11.9
SF-3765	21	57.1	31.7	31.7	13.5
SF-3766	22	57.1	33.3	33.3	14.3
SF-3767	23	57.1	34.9	34.9	15.9
SF-3768	24	57.1	34.9	34.9	15.9

Surface Drive, Thin Wall, Standard Length

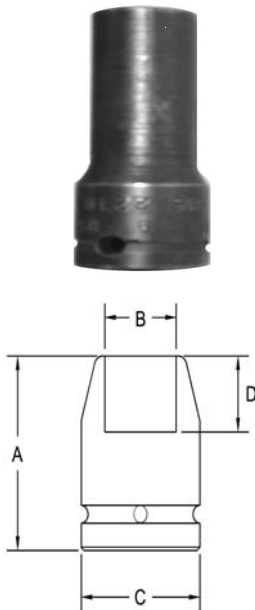

Part # Surface Drive	Hex Opening	Overall Length (A)	Diameter Nose (B)	Diameter Drive End (C)	Opening Depth (D)
SF-3788	10	82.5	16.7	23.8	6.4
SF-3789	11	82.5	17.5	23.8	7.2
SF-3790	12	82.5	19.1	23.8	7.2
SF-3791	13	82.5	22.2	23.8	11.1
SF-3792	14	82.5	22.2	23.8	11.1
SF-3793	15	82.5	23.8	23.8	11.1
SF-3794	16	82.5	25.4	25.4	11.1
SF-3795	17	82.5	28.6	28.6	11.1
SF-3796	18	82.5	28.6	28.6	11.1
SF-3797	19	82.5	28.6	28.6	11.9
SF-3798	21	88.9	31.7	31.7	13.5
SF-3799	22	88.9	33.3	33.3	14.3
SF-3800	23	88.9	34.9	34.9	15.9
SF-3801	24	88.9	34.9	34.9	15.9

Sockets can be configured with the following options:

FM = Fixed Magnet SD = Side Magnet TM = Tubular Magnet

SM = Spring Magnet FL = Fast Lead

Fixed and rotating UHMW plastic sleeves can be special ordered