

# 1/2" Square Drive Sockets METRIC

## Surface Drive, Standard Length

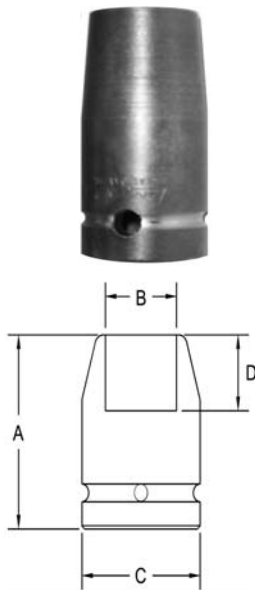

Part # Surface Drive	Hex Opening	Overall Length (A)	Diameter Nose (B)	Diameter Drive End (C)	Opening Depth (D)
SF-3690	10	38.1	16.7	23.8	6.4
SF-3691	11	38.1	17.5	23.8	7.2
SF-3692	12	38.1	19.1	23.8	7.2
SF-3693	13	38.1	22.2	23.8	8.7
SF-3694	14	38.1	23.8	23.8	11.1
SF-3695	15	38.1	23.8	23.8	11.1
SF-3696	16	38.1	25.4	25.4	11.1
SF-3697	17	38.1	28.6	28.6	11.1
SF-3698	18	38.1	28.6	28.6	11.1
SF-3699	19	38.1	28.6	28.6	11.1
SF-3700	20	38.1	31.7	31.7	11.9
SF-3701	21	38.1	31.7	31.7	11.9
SF-3702	22	38.1	33.3	33.3	14.3
SF-3703	23	38.1	34.9	34.9	15.9
SF-3704	24	38.1	34.9	34.9	15.9

## Surface Drive, Thin Wall, Standard Length

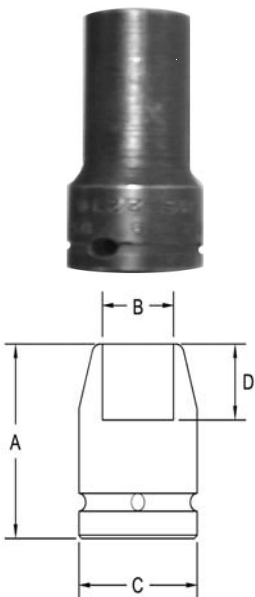

Part # Surface Drive	Hex Opening	Overall Length (A)	Diameter Nose (B)	Diameter Drive End (C)	Opening Depth (D)
SF-3724	10	38.1	15.9	23.8	6.4
SF-3725	11	38.1	16.7	23.8	7.2
SF-3726	12	38.1	17.5	23.8	7.2
SF-3727	13	38.1	18.7	23.8	8.7
SF-3728	14	38.1	20.6	23.8	11.1
SF-3729	15	38.1	22.2	23.8	11.1
SF-3730	16	38.1	22.2	23.8	11.1
SF-3731	17	38.1	23.8	23.8	11.1
SF-3732	18	38.1	25.4	25.4	11.1
SF-3733	19	38.1	26.3	26.3	11.9
SF-3734	20	38.1	27.0	28.6	11.9
SF-3735	21	38.1	28.6	28.6	11.9
SF-3736	22	38.1	30.2	31.7	11.

**Sockets can be configured with the following options:**  
**FM = Fixed Magnet    SD = Side Magnet    TM = Tubular Magnet**  
**SM = Spring Magnet    FL = Fast Lead**  
 Fixed and rotating UHMW plastic sleeves can be special ordered