

# 1/2" Square Drive Sockets METRIC

## 6 Point and Double Hex, Thin Wall, Extra Long Length

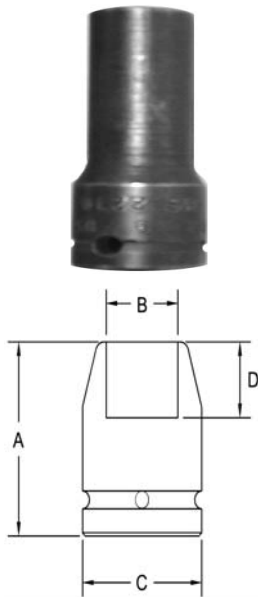

Part # 6 Point	Part # Double Hex	Hex Opening	Overall Length (A)	Diameter Nose (B)	Diameter Drive End (C)	Opening Depth (D)
3650	3650-D	10	82.5	15.9	23.8	6.4
3651	3651-D	11	82.5	16.7	23.8	7.2
3652	3652-D	12	82.5	17.5	23.8	7.2
3653	3653-D	13	82.5	18.7	23.8	8.7
3654	3654-D	14	82.5	20.6	23.8	11.1
3655	3655-D	15	82.5	22.2	23.8	11.1
3656	3656-D	16	82.5	22.2	23.8	11.1
3657	3657-D	17	82.5	23.8	23.8	11.1
3658	3658-D	18	82.5	25.4	25.4	11.1
3659	3659-D	19	82.5	26.3	26.3	11.9
3660	3660-D	20	82.5	28.6	28.6	11.9
3661	3661-D	21	88.9	28.6	28.6	13.5
3662	3662-D	22	88.9	30.2	31.7	14.3
3663	3663-D	23	88.9	31.7	31.7	15.9
3664	3664-D	24	88.9	33.3	33.3	15.9
3665	3665-D	26	88.9	34.9	34.9	15.9
3666	3666-D	27	88.9	36.5	38.1	17.5
3667	3667-D	28	88.9	36.5	38.1	19.1
3668	3668-D	29	88.9	38.1	38.1	19.1
3669	3669-D	30	88.9	39.7	41.1	19.1
3670	3670-D	32	88.9	42.9	42.9	20.6

**Sockets can be configured with the following options:**  
**FM = Fixed Magnet    SD = Side Magnet    TM = Tubular Magnet**  
**SM = Spring Magnet    FL = Fast Lead**  
**Fixed and rotating UHMW plastic sleeves can be special ordered**