

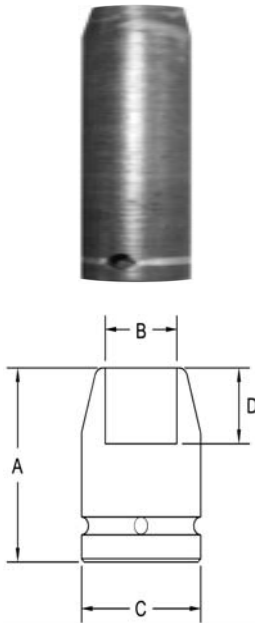

1/2" Square Drive Sockets METRIC 6 Point and Double Hex, Long Length



Part # 6 Point	Part # Double Hex	Hex Opening	Overall Length (A)	Diameter Nose (B)	Diameter Drive End (C)	Opening Depth (D)
3575	3575-D	10	57.1	16.7	23.8	6.4
3576	3576-D	11	57.1	17.5	23.8	7.2
3577	3577-D	12	57.1	19.1	23.8	7.2
3578	3578-D	13	57.1	22.2	23.8	8.7
3579	3579-D	14	57.1	22.2	23.8	11.1
3580	3580-D	15	57.1	23.8	23.8	11.1
3581	3581-D	16	57.1	25.4	25.4	11.1
3582	3582-D	17	57.1	28.6	28.6	11.1
3583	3583-D	18	57.1	28.6	28.6	11.1
3584	3584-D	19	57.1	28.6	28.6	11.9
3585	3585-D	20	57.1	31.7	31.7	11.9
3586	3586-D	21	57.1	31.7	31.7	13.5
3587	3587-D	22	57.1	33.3	33.3	14.3
3588	3588-D	23	57.1	34.9	34.9	15.9
3589	3589-D	24	57.1	34.9	34.9	15.9
3590	3590-D	25	57.1	38.1	38.1	15.9
3591	3591-D	26	57.1	38.1	38.1	15.9
3592	3592-D	27	60.3	41.3	41.3	17.5
3593	3593-D	28	60.3	41.3	41.3	19.1
3594	3594-D	29	60.3	44.4	44.4	19.1
3595	3595-D	30	60.3	44.4	44.4	19.1
3596	3596-D	32	60.3	44.4	44.4	20.6

Sockets can be configured with the following options:
FM = Fixed Magnet SD = Side Magnet TM = Tubular Magnet
SM = Spring Magnet FL = Fast Lead
Fixed and rotating UHMW plastic sleeves can be special ordered