

# 1/2" Square Drive Sockets

## 6 Point and Double Hex, Thin Wall, Standard Length

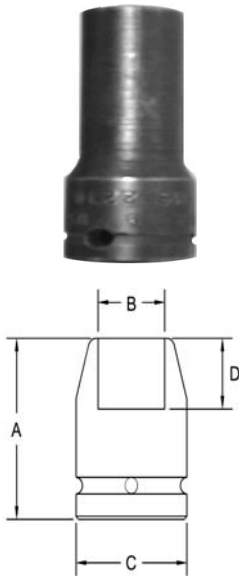

| Part #<br>6 Point | Part #<br>Double Hex | Hex<br>Opening | Overall<br>Length (A) | Diameter<br>Nose (B) | Diameter<br>Drive End (C) | Opening<br>Depth (D) |
|-------------------|----------------------|----------------|-----------------------|----------------------|---------------------------|----------------------|
| 3055              | 3055-D               | 5/16           | 1.50                  | .593                 | .937                      | .250                 |
| 3056              | 3056-D               | 3/8            | 1.50                  | .593                 | .937                      | .250                 |
| 3057              | 3057-D               | 7/16           | 1.50                  | .656                 | .937                      | .281                 |
| 3058              | 3058-D               | 1/2            | 1.50                  | .718                 | .937                      | .343                 |
| 3059              | 3059-D               | 9/16           | 1.50                  | .812                 | .937                      | .437                 |
| 3060              | 3060-D               | 5/8            | 1.50                  | .875                 | .937                      | .437                 |
| 3061              | 3061-D               | 21/32          | 1.50                  | .906                 | .937                      | .437                 |
| 3062              | 3062-D               | 11/16          | 1.50                  | .937                 | .937                      | .437                 |
| 3063              | 3063-D               | 3/4            | 1.50                  | 1.03                 | 1.03                      | .468                 |
| 3064              | 3064-D               | 3/4            | 1.50                  | 1.03                 | 1.12                      | .468                 |
| 3065              | 3065-D               | 25/32          | 1.50                  | 1.06                 | 1.12                      | .468                 |
| 3066              | 3066-D               | 13/16          | 1.50                  | 1.12                 | 1.12                      | .531                 |
| 3067              | 3067-D               | 7/8            | 1.50                  | 1.18                 | 1.25                      | .562                 |
| 3068              | 3068-D               | 15/16          | 1.50                  | 1.25                 | 1.25                      | .625                 |
| 3069              | 3069-D               | 1              | 1.50                  | 1.37                 | 1.37                      | .625                 |
| 3070              | 3070-D               | 1 1/16         | 1.62                  | 1.43                 | 1.43                      | .687                 |
| 3071              | 3071-D               | 1 1/8          | 1.62                  | 1.50                 | 1.50                      | .750                 |
| 3072              | 3072-D               | 1 3/16         | 1.62                  | 1.62                 | 1.62                      | .750                 |
| 3073              | 3073-D               | 1 1/4          | 1.75                  | 1.68                 | 1.75                      | .812                 |
| 3074              | 3074-D               | 1 5/16         | 1.75                  | 1.78                 | 1.87                      | .812                 |

**Sockets can be configured with the following options:**  
**FM = Fixed Magnet    SD = Side Magnet    TM = Tubular Magnet**  
**SM = Spring Magnet    FL = Fast Lead**  
**Fixed and rotating UHMW plastic sleeves can be special ordered**