

1" Square Drive Sockets METRIC

6 Point and Double Hex Standard Length

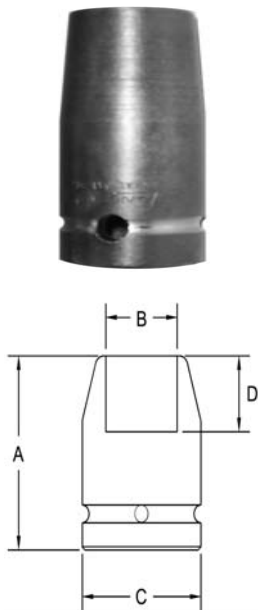

Part # 6 Point	Part # Double Hex	Hex Opening	Overall Length (A)	Diameter Nose (B)	Diameter Drive End (C)	Opening Depth (D)
6280	6280-D	21	54	34.9	50.8	13.5
6281	6281-D	22	54	38.1	50.8	14.2
6282	6282-D	23	54	38.1	50.8	20.6
6283	6283-D	24	54	38.1	50.8	20.6
6284	6284-D	25	54	41.3	50.8	20.6
6285	6285-D	26	54	41.3	50.8	20.6
6286	6286-D	27	54	42.9	50.8	20.6
6287	6287-D	28	54	44.4	50.8	20.6
6288	6288-D	29	54	47.6	50.8	20.6
6289	6289-D	30	54	50.8	50.8	20.6
6290	6290-D	30	54	44.4	54.0	20.6
6291	6291-D	32	54	54.0	54.0	20.6
6292	6292-D	33	54	54.0	54.0	20.6
6293	6293-D	34	54	54.0	54.0	20.6
6294	6294-D	35	54	54.0	54.0	20.6
6295	6295-D	36	57	57.1	54.0	23.9
6296	6296-D	37	57	57.1	54.0	23.9
6297	6297-D	38	57	57.1	54.0	23.9
6298	6298-D	41	60	63.5	54.0	23.9
6299	6299-D	42	60	63.5	54.0	23.9
6300	6300-D	46	64	69.8	66.7	26.9
6301	6301-D	47	64	69.8	66.7	26.9
6302	6302-D	48	64	69.8	66.7	26.9
6303	6303-D	50	66	76.2	66.7	30.2

Sockets can be configured with the following options:

FM = Fixed Magnet SD = Side Magnet TM = Tubular Magnet

SM = Spring Magnet FL = Fast Lead

Fixed and rotating UHMW plastic sleeves can be special ordered