

1" Square Drive Universal Socket 6 Point

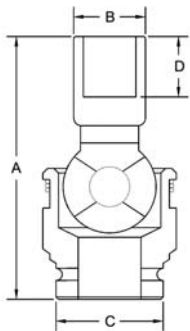

Part # 6 Point	Hex Opening	Overall Length (A)	Diameter Nose (B)	Diameter Drive End (C)	Opening Depth (D)
UA6430	7/8	5.20	1.54	2.28	.79
UA6431	15/16	5.20	1.57	2.28	.79
UA6432	1	5.20	1.65	2.28	.79
UA6433	1 1/16	5.20	1.73	2.28	.79
UA6434	1 1/8	5.20	1.81	2.28	.79
UA6435	1 3/16	5.20	1.97	2.28	.79
UA6436	1 1/4	5.20	2.05	2.28	.79
UA6437	1 5/16	5.20	2.17	2.28	.83
UA6438	1 3/8	5.20	2.17	2.28	.91
UA6439	1 7/16	5.20	2.20	2.28	.91
UA6440	1 1/2	5.39	2.32	2.28	.94
UA6441	1 9/16	5.39	2.44	2.28	.94
UA6442	1 5/8	5.39	2.48	2.28	1.02
UA6443	1 11/16	5.39	2.60	2.28	1.02
UA6444	1 3/4	5.59	2.68	2.28	1.18
UA6445	1 13/16	5.59	2.72	2.28	1.18
UA6446	1 7/8	5.59	2.87	2.28	1.18
UA6447	1 15/16	5.59	2.91	2.28	1.22
UA6448	2	5.59	2.99	2.28	1.22

Sockets can be configured with the following options:

FM = Fixed Magnet