

1" Square Drive Sockets 6 Point and Double Hex Long Length

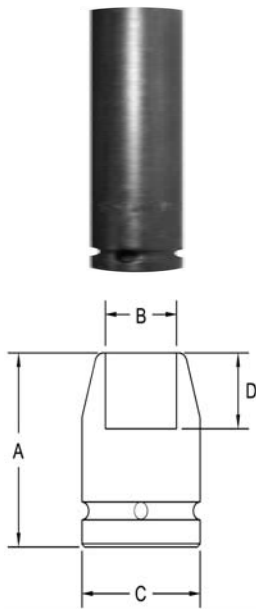

Part # 6 Point	Part # Double Hex	Hex Opening	Overall Length (A)	Diameter Nose (B)	Diameter Drive End (C)	Opening Depth (D)
6100	6100-D	13/16	3	1.37	2.12	.531
6101	6101-D	7/8	3	1.43	2.12	.562
6102	6102-D	15/16	3	1.50	2.12	.625
6103	6103-D	1	3	1.62	2.12	.625
6104	6104-D	1 1/8	3	1.75	2.12	.750
6105	6105-D	1 1/4	3	2.12	2.12	.812
6106	6106-D	1 5/16	3	2.12	2.12	.812
6107	6107-D	1 3/8	3	2.12	2.12	.812
6108	6108-D	1 7/16	3	2.25	2.12	.937
6109	6109-D	1 1/2	3.25	2.25	2.12	.937

Sockets can be configured with the following options:

FM = Fixed Magnet SD = Side Magnet TM = Tubular Magnet

SM = Spring Magnet FL = Fast Lead

Fixed and rotating UHMW plastic sleeves can be special ordered