

1" Square Drive Impact Hex Drivers

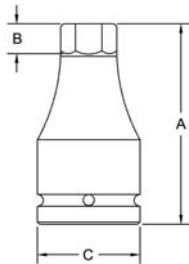

Part # Hex	Hex Size	Overall Length (A)	Depth Nose (B)	Diameter Drive End (C)
0330	5/8	3.94	.79	2.13
0331	3/4	3.94	.79	2.13
0332	13/16	3.94	.79	2.13
0333	7/8	3.94	.79	2.13
0334	1	3.94	.79	2.13
0334	1 1/16	3.94	.79	2.13
0335	1 1/8	3.94	.79	2.13
0336	1 3/16	3.94	.79	2.13
0337	1 1/4	3.94	.79	2.13
0338	1 5/16	3.94	.79	2.13
0339	1 3/8	3.94	.79	2.13
0340	1 1/2	3.94	.79	2.13
0341	1 5/8	3.94	.79	2.13
0342	1 3/4	3.94	.798	2.13

Sockets can be configured with the following options:
FM = Fixed Magnet SD = Side Magnet TM = Tubular Magnet
SM = Spring Magnet FL = Fast Lead
Fixed and rotating UHMW plastic sleeves can be special ordered