

3/8" Square Drive Sockets For Square Nuts Single Square and Double Square

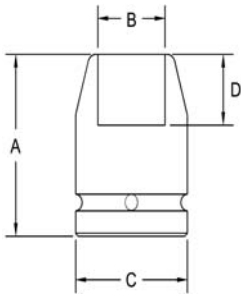

Part # Square	Part # Double Sq	Square Opening	Overall Length (A)	Diameter Nose (B)	Diameter Drive End (C)	Opening Depth (D)
2240	2240-D	7/32	1.50	.437	.750	.187
2241	2241-D	1/4	1.50	.500	.750	.187
2242	2242-D	9/32	1.50	.562	.750	.187
2243	2243-D	5/16	1.50	.625	.750	.250
2244	2244-D	3/8	1.50	.750	.750	.250
2245	2245-D	7/16	1.50	.875	.875	.281
2246	2246-D	1/2	1.50	1.00	1.00	.343
2247	2247-D	9/16	1.50	1.00	1.00	.437
2248	2248-D	5/8	1.50	1.12	1.12	.437
2249	2249-D	11/16	1.50	1.25	1.25	.437
2250	2250-D	3/4	1.50	1.37	1.37	.468

Sockets can be configured with the following options:
FM = Fixed Magnet SD = Side Magnet TM = Tubular Magnet
SM = Spring Magnet FL = Fast Lead
 Fixed and rotating UHMW plastic sleeves can be special ordered

3/8" Square Drive Universal Wrenches 6 Point

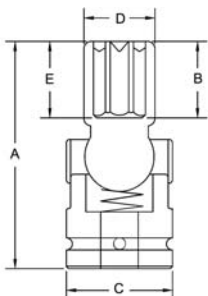

Part # 6 Point	Hex Opening	Overall Length (A)	Socket Length (B)	Socket Diameter (C)	Nose End Diameter (D)	Clearance Depth (E)
UA224	5/16	2.09	.51	.95	.437	.35
UA225	3/8	2.09	.51	.95	.562	.35
UA227	7/16	2.09	.51	.95	.593	.35
UA229	1/2	2.09	.51	.95	.750	.43
UA232	9/16	2.09	.51	.95	.812	.43
UA235	5/8	2.09	.51	.95	.875	.43
UA237	11/16	2.09	.51	.95	1.00	.43
UA238	3/4	2.09	.51	.95	1.12	.43

Sockets can be configured with the following options:
FM = Fixed Magnet