

# 3/8" Square Drive Sockets

## 6 Point and Double Hex, Thin Wall, Standard Length

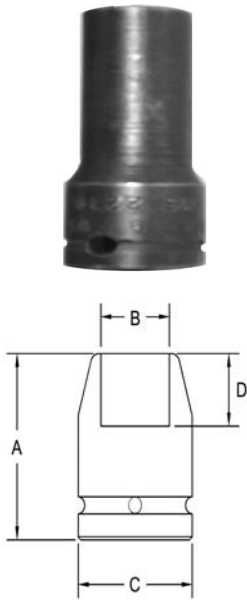

Part # 6 Point	Part # Double Hex	Hex Opening	Overall Length (A)	Diameter Nose (B)	Diameter Drive End (C)	Opening Depth (D)
2040	2040-D	1/4	1.25	.437	.750	.156
2041	2041-D	9/32	1.25	.437	.750	.187
2042	2042-D	5/16	1.25	.500	.750	.187
2043	2043-D	11/32	1.25	.500	.750	.187
2044	2044-D	3/8	1.50	.593	.750	.250
2045	2045-D	7/16	1.50	.625	.750	.281
2046	2046-D	1/2	1.50	.750	.750	.343
2047	2047-D	9/16	1.50	.781	.812	.437
2048	2048-D	5/8	1.50	.875	.875	.437
2049	2049-D	11/16	1.50	.937	.937	.437
2050	2050-D	3/4	1.50	1.00	1.00	.468
2051	2051-D	13/16	1.50	1.12	1.12	.531
2052	2052-D	7/8	1.50	1.18	1.25	.562
2053	2053-D	15/16	1.50	1.31	1.31	.625
2054	2054-D	1	1.50	1.37	1.37	.625
2055	2055-D	1 1/16	1.50	1.50	1.50	.687

**Sockets can be configured with the following options:**  
**FM = Fixed Magnet    SD = Side Magnet    TM = Tubular Magnet**  
**SM = Spring Magnet    FL = Fast Lead**  
**Fixed and rotating UHMW plastic sleeves can be special ordered**